

LIST OF PARTS



MACHINE No. 138w103

** A TRADE MARK OF

THE SINGER MANUFACTURING COMPANY

INSTRUCTIONS FOR OILING

To ensure easy running and prevent unnecessary wear of the parts which are in movable contact, the machine requires oiling and when in continuous use, "TYPE B" or "TYPE D" OIL, sold only by Singer Sewing Machine Company, should be applied at least twice each day to all oil holes marked "OIL", as instructed in Form 2312w.

"TYPE D" OIL is stainless.

To insure satisfactory results, "TYPE E" Stainless Thread Lubricant, sold only by Singer Sewing Machine Company, should be used in the thread lubricator.

The small felt pad on the side of the bobbin case should be kept wet with oil to lubricate the hook race.

Copyright, U. S. A., 1939, 1940, 1941, 1951 and 1952
by The Singer Manufacturing Company
All Rights Reserved for All Countries

INDEX

	Page
Accessories.....	14
Bobbin Winders	14 & 16
Foot Lifter.....	16
Knee Lifter	15
Machine No. 138w103	5
Miscellaneous Parts	17
Numerical List of Parts	19
Thread Unwinder	15

INSTRUCTIONS FOR ORDERING

In ordering from this list, use **ONLY** the **PART** number in the **FIRST** column.

The number stamped on a Sewing Machine Part is the number of the Single Part only, except when the part includes Set Screws, Clamping Screws, Studs and Rollers Spun on, Small Wires riveted, or Parts soldered together, etc., which it is necessary to furnish in combination.

Every combination of parts sent out has its specific number which, although not stamped on Parts (except in above case), must be used when ordering the combination.

Each number always indicates the **SAME PART** in whatever list it appears, or for whatever Machine.

The letters after some of the numbers indicate the style of finish only, as follows:

- A Hardened, Polished, Nickel Plated and Buffed.
- AL Heat Treated for Toughness.
- B Polished, Nickel Plated and Buffed.
- C Hardened only.
- D Polished only.
- E Soft, Not polished.
- F Hardened and Polished.
- H Blued.
- J Nickel Plated only.
- R Merlized.
- X Black Oxide, for Iron and Steel.
- XC Hardened and Black Oxide, for Iron and Steel.
- Y Black Nickel Plated only.
- Z Chromium Plated.

These letters **MUST BE USED** when they appear in the list and **AFTER** the number, as in the list.

In this series

1 to 1500, 200001 to 201500 and 350001 to 351500 are Screw Numbers.
1501 to 1800, 201501 to 201800 and 351501 to 351800 are Nut Numbers.
1801 to 2000, 201801 to 202000 and 351801 to 352000 are Roller Numbers.
2001 to 50000 and 202001 to 350000 are Numbers of Machine Parts.

The figures in the second column refer only to the plate in which the illustration of the part is shown and are **NOT TO BE USED** in ordering.

Two or more numbers over a cut indicate that the difference between such parts is not visible in an illustration.

Parts marked with an asterisk (*) are furnished only when repairs are made at the factory.

LIST OF PARTS COMPLETE
FOR

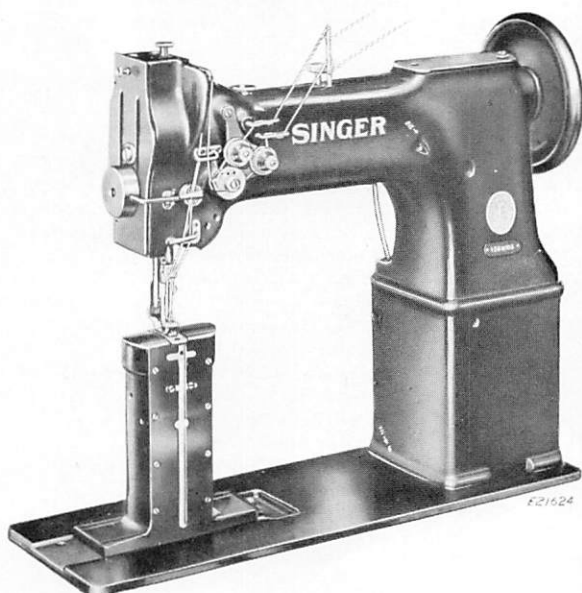

MACHINE No. 138w103

HIGH SPEED. TWO NEEDLE.

COMPOUND FEED POST MACHINE.

ALTERNATING PRESSERS.

FOR LEATHER WORK REQUIRING HEAVY THREAD.

MADE IN GAUGES FROM $\frac{3}{16}$ TO $\frac{3}{4}$ INCH

No.	Plate	Name
*264201	-----	Arm with 202135
264002	-----	" Base
204235	15797	" " Position Pin (2)
200004E	15797	" " Screw (3)
202005	15797	" " " Washer (3)
224002	15790	" Cap
200278H	15790	" " Screw
202248	15790	" " " Washer
204235	15797	" Position Pin (2)
200004E	15797	" Screw (3)
202005	15797	" " Washer (3)
264202	15790	" Shaft with 224392 and 350431E

No.	Plate	Name
240802	15790	Arm Shaft Bushing (back) with 202244
202244	15790	" " " " Oil Packing (wick)
200338C	15790	Arm Shaft Bushing (back) Set Screw
207080	15790	" " " (front) with 202244
202244	15790	" " " " Oil Packing (wick)
200502H	15790	Arm Shaft Bushing (front) Oil Packing Thumb Screw
200338C	15790	Arm Shaft Bushing (front) Set Screw
264004	16052	" " Connection Belt
224104	16052	" " " " Pulley with 200327C, 200602C and two 202253
200602C	16052	Arm Shaft Connection Belt Pulley Position Screw
200327C	16052	Arm Shaft Connection Belt Pulley Set Screw
202253	16052	Arm Shaft Connection Belt Pulley Spring Flange
224113	16053	Arm Shaft Connection Belt Timing Collar with 200113F
200113F	16053	Arm Shaft Connection Belt Timing Collar Set Screw
224139	16053	Arm Shaft Connection Belt Timing Plate
200164B	16053	Arm Shaft Connection Belt Timing Plate Screw (2)
224392	15790	Arm Shaft Oil Packing (wick)
350431E	15790	" " " " Stop Screw
237577	15790	Balance Wheel (belt groove 4 in. diam.) with two 200338C
200338C	15790	Balance Wheel Set Screw
*264005	-----	Bed with 54897
202258	16052	" Hinge Connection (2)
200570E	16052	" " " Screw (4)
54897	16053	" Oil Cup
264113	16053	" " Guard with 223814
223814	16053	" " " Felt
200096D	16053	" " " Screw (2)
233939	15791	Bobbin
264203	15791	" Case Base (eccentric) with 202056, 203211 to 203213 and 203216
203211	15791	Bobbin Case Base Latch
*202056	-----	" " " " Pin
203212	15791	" " " " Plunger
203213	15791	" " " " Spring
264204	15791	" " Cap with 200594C, 200984C, 203377, 241674, 241675 and two 350405C
264205	15792	Bobbin Case Lever
264206	15792	" " " Driving Block
200126D	15792	" " " " Screw
264207	15792	" " " " Swivel
201370D	15792	" " " " " " Hinge Screw
201272C	15792	Bobbin Case Lever Hinge Screw
241674	15791	" " Oiling Felt

No.	Plate	Name
241675	15791	Bobbin Case Oiling Felt Retainer
350405C	15791	" " " " " Screw
203377	15791	" " Tension Spring
200984C	15791	" " " " Regulating Screw
200594C	15791	Bobbin Case Tension Spring Screw
203216	15791	" " Washer (cloth)
264209	15791	Bobbin Case complete, Nos. 264203 and 264204
240179	15797	Face Plate with 201650H and 350432XC
202135	15797	" " Position Pin
200473H	15797	" " Thumb Screw
264006	16054	Feed Bar
264007	16054	" " 264006 with 200040C, 224052 and 225837
350393C	16054	Feed Bar Hinge Screw (driving)
201518E	16054	" " " " Nut
264210	15793	" Dog, 30 needle hole, for needle sizes 25 and 26, in 3/16, 7/32 and 1/4 in. gauge, for 264237
264211	15793	Feed Dog, 30 needle hole, for needle sizes 25 and 26, in 9/32, 5/16, 11/32, 3/8 and 13/32 in. gauge, for 264238
264031	15793	Feed Dog Lever
200263D	15793	" " " Hinge Screw
201528D	15793	" " " " " Nut
264032	15793	" " " Post
264033	15793	" " " 264032 with 200943F, 201525E, 203624, 264031, 264035 and two 200098E
264034	15793	Feed Dog Lever Post Oil Guard (2)
200132E	15793	" " " " " " Screw (2)
200024C	15793	Feed Dog Lever Post Screw (4)
203637	15793	" " " " " Washer (4)
203624	15793	" " " Retainer Washer
200098E	15793	" " " " " Screw
264035	15793	" " " Slide Block
200943F	15793	" " " " " Hinge Screw
201525E	15793	Feed Dog Lever Slide Block Hinge Screw Nut
200098E	15793	Feed Dog Screw
264008	16052	" Driving Connection with 200049D and 202277
201171C	16052	Feed Driving Connection Hinge Screw
201517E	16052	" " " " " " Nut
202277	16052	Feed Driving Connection Hinge Screw Oil Packing (wick)
202277	16052	Feed Driving Connection Oil Packing (wick)
200049D	16052	Feed Driving Connection Pinch Screw
202300	16052	" " Eccentric Regulating Bracket
224107	16052	Feed Driving Eccentric Regulating Bracket 202300 with 224108, two each 200256C and 201525E

No.	Plate	Name
224108	16052	Feed Driving Eccentric Regulating Bracket Flange with 200383C and 200437C
200437C	16052	Feed Driving Eccentric Regulating Bracket Flange Position Screw
200383C	16052	Feed Driving Eccentric Regulating Bracket Flange Set Screw
200256C	16052	Feed Driving Eccentric Regulating Bracket Hinge Screw
201525E	16052	Feed Driving Eccentric Regulating Bracket Hinge Screw Nut
237001	16052	Feed Driving Eccentric Regulating Bracket Plunger
237002	16052	Feed Driving Eccentric Regulating Bracket Plunger Spring
200607C	16052	Feed Driving Eccentric Regulating Bracket Plunger Spring Stop Screw
200256C	16052	Feed Driving Eccentric Regulating Bracket Stop Screw
201525E	16052	Feed Driving Eccentric Regulating Bracket Stop Screw Nut
200429C	16052	Feed Driving Eccentric Regulating Screw
200383C	16052	Feed Driving Eccentric Regulating Screw Check Screw
223650	16054	Feed Driving Rock Shaft
264009	16054	" " " " 223650 with 201518E, 264007 and 350393C
223652	16054	Feed Driving Rock Shaft Crank with 200019E
200019E	16054	Feed Driving Rock Shaft Crank Pinch Screw
202625	16054	Feed Driving Rock Shaft Stop Collar with two 200383C (2)
200383C	16054	Feed Driving Rock Shaft Stop Collar Set Screw
224154	16053	Feed Lifting Cam with 201220C
224052	16054	" " " Fork with 200173D and 223655
200040C	16054	Feed Lifting Cam Fork Screw
225837	16054	" " " " " Washer
223655	16054	" " " Oiling Felt
200173D	16054	" " " " " Screw
201220C	16053	" " " Set Screw
224122	15790	" Regulating Spindle with 202311, 202443 and 202619
*202311	-----	Feed Regulating Spindle Head
202443	15790	" " " " " Pin
202619	15790	" " " " " Position Pin
*264214	-----	Hook (sewing)
264215	15791	" 264214 with 201253F, 201376C and 264217
264216	15791	Hook and Bobbin Case complete, Nos. 264209 and 264215
223867	16053	Hook Driving Gear (spiral) with 200362C and 201222C (2)

No.	Plate	Name
201222C	16053	Hook Driving Gear Position Screw
200362C	16053	" " " Set Screw
224110	16053	" " Shaft
224111	16053	" " " Bushing (back) with 202244
202244	16053	Hook Driving Shaft Bushing (back) Oil Packing (wick)
200327C	16053	Hook Driving Shaft Bushing (back) Set Screw
264038	16053	Hook Driving Shaft Bushing (center)
200335C	16053	" " " " " Set Screw
264039	16053	Hook Driving Shaft Bushing (front)
200327C	16053	" " " " " Set Screw
224112	16053	Hook Driving Shaft Connection Belt Pulley with 202253 and two 201254C
201254C	16053	Hook Driving Shaft Connection Belt Pulley Set Screw
202253	16053	Hook Driving Shaft Connection Belt Pulley Spring Flange
264217	15791	Hook Gib
201376C	15791	" " Hinge Screw
201253F	15791	" " Screw
264218	15792	" Post
264219	15792	" " 264218 with 200555H, 201272C, 201370D, 203718, 224021, 249072, 264156, 264205 to 264207, 264216, two each 200126D and 200138D
264220	15792	Hook Post 264219 with 221215, 264044, 264046, two 264048 and eight 200583H
264221	15792	Hook Post 264219 with 221215, 264045, 264047, two 264048 and eight 200583H
200159F	15793	Hook Post Clamping Screw (2)
264044	15792	" " Cover Plate (back) (inside) for machines in gauges from 3/16 to 17/32 inch
221209	15792	Hook Post Cover Plate (back) (inside) for machines in gauges from 9/16 to 3/4 inch
264045	15792	Hook Post Cover Plate (back) (outside) for machines in gauges from 3/16 to 17/32 inch
241507	15792	Hook Post Cover Plate (back) (outside) for machines in gauges from 9/16 to 3/4 inch
264046	15792	Hook Post Cover Plate (front) (inside) for machines in gauges from 3/16 to 17/32 inch
264121	15792	Hook Post Cover Plate (front) (inside) for machines in gauges from 9/16 to 3/4 inch
264047	15792	Hook Post Cover Plate (front) (outside) for machines in gauges from 3/16 to 17/32 inch
264120	15792	Hook Post Cover Plate (front) (outside) for machines in gauges from 9/16 to 3/4 inch

No.	Plate	Name
264048	15792	Hook Post Cover Plate Gasket
200583H	15792	" " " " Screw
249072	15792	" " Oil Packing (wick)
200138D	15792	" " " " " Screw
200008C	15792	" " Screw (4)
203637	15792	" " " Washer (4)
221215	15792	" " Slide
264156	15792	" Socket
224021	15792	" " Gear with two 200382C
200382C	15792	" " " Set Screw
200555H	15792	" " Screw
203718	15791	" Washer
264050	15797	Knee Lifter Connection Lever
200262H	15797	" " " " Hinge
		Screw
264051	15797	Knee Lifter Connection Lever Lifting
		Rod with 202302
202302	15797	Knee Lifter Connection Lever Lifting
		Rod Cotter Pin
240175	15797	Knee Lifter Lifting Lever
200262H	15797	" " " " Hinge Screw
240205	15795	Lifting Bell Crank
200996C	15795	" " " Cap Screw
240125	17258	" " " Link
350172C	17258	" " " " Screw Stud
201524E	17258	" " " " " " Nut
*237195	17258	Lifting Eccentric
*237749	17258	" " " Body
350107C	17258	" " " Position Screw
443C	17258	" " " Set Screw
240126	17258	" " " Connection
240171	17258	" " " Crank with
		200029E and 248821
248821	17258	Lifting Eccentric Connection Crank Oil
		Packing (wick)
200029E	17258	Lifting Eccentric Connection Crank
		Pinch Screw
1103C	17258	Lifting Eccentric Regulating Screw
217D	17258	" " " Set Screw
7071	17258	" " " Washer
237196	17258	Lifting Eccentric complete, Nos. 217D,
		443C, 1103C, 7071, 237195, 237749
		and 350107C
264224	15795	Lifting Presser Foot, in gauges from
		3/16 to 13/32 in., in steps of 1/32
		in., for 264241
200074F	15795	Lifting Presser Foot Screw
240136	17258	" Rock Shaft with 201524E and
		350172C
240174	17258	Lifting Rock Shaft Bushing (2)
264226	15794	Needle Bar and Holder, in gauges from
		3/16 to 5/8 in., in steps of 1/32 in.,
		with two 200141F
238251	15794	Needle Bar Connecting Link
264718	15794	" " " " Oil Guard
201183D	15794	" " " " " "
		Screw

No.	Plate	Name
202333	15794	Needle Bar Connecting Link Stud with 202254
202254	15794	Needle Bar Connecting Link Stud Oil Packing (wick)
200374C	15794	Needle Bar Connecting Link Stud Set Screw
200383C	15794	Needle Bar Connecting Link Stud Set Screw
208552	15794	Needle Bar Connecting Stud with 200086C and 202330
202330	15794	Needle Bar Connecting Stud Oil Packing (wick)
200086C	15794	Needle Bar Connecting Stud Pinch Screw
202692	15794	Needle Bar Crank with 200335C, 200374C, 200383C, 200428C and 202333
264228	15794	Needle Bar Crank 202692 with 202400, 208552, 238251, 264229 and 264629
203172	15794	Needle Bar Crank Friction Washer
200428C	15794	" " " Position Screw
200335C	15794	" " " Set Screw
240138	15794	" " " Rock Frame
210910	15794	" " " " Hinge Stud with 202277
202277	15794	Needle Bar Rock Frame Hinge Stud Oil Packing (wick)
200347C	15794	Needle Bar Rock Frame Hinge Stud Set Screw
202666	15794	Needle Bar Rock Frame Position Bracket
200098F	15794	Needle Bar Rock Frame Position Bracket Screw
223690	17258	Needle Bar Rock Frame Rock Shaft
223691	17258	" " " " " "
		223690 with 200387C and 210920
264112	17258	Needle Bar Rock Frame Rock Shaft Crank with 200029E
264052	16052	Needle Bar Rock Frame Rock Shaft Crank Connection with 202277
200833C	16052	Needle Bar Rock Frame Rock Shaft Crank Connection Hinge Screw
201522E	16052	Needle Bar Rock Frame Rock Shaft Crank Connection Hinge Screw Nut
202277	16052	Needle Bar Rock Frame Rock Shaft Crank Connection Oil Packing (wick)
200029E	17258	Needle Bar Rock Frame Rock Shaft Crank Pinch Screw
202668	17258	Needle Bar Rock Frame Slide Block
210920	17258	" " " " " "
		202668 with 201141C
201141C	17258	Needle Bar Rock Frame Slide Block Screw Stud
200387C	17258	Needle Bar Rock Frame Slide Block Screw Stud Set Screw
200141F	15794	Needle Set Screw
208566	15795	Presser Bar with 200074F

No.	Plate	Name
235871	15795	Presser Bar Bushing (lower)
207072	15795	" " " (upper)
200352C	15795	" " " Set Screw (2)
202671	15795	" " Lifter
200653C	15795	" " " Hinge Screw
208555	15795	" " Lifting Bracket with 200054E
200975F	15795	Presser Bar Lifting Bracket Guide Screw
200054E	15795	Presser Bar Lifting Bracket Pinch Screw
202337	15795	Presser Bar Position Guide
202338	15795	" " " " Lever with 200086F
200086F	15795	Presser Bar Position Guide Lever Pinch Screw
200352C	15795	Presser Bar Position Guide Set Screw
240172	15797	" " Spring (flat) heavy
210949	15795	" " " Bracket with 200086C
200086C	15795	Presser Bar Spring Bracket Pinch Screw
201410F	15797	Presser Bar Spring Regulating Screw
200948F	15797	" " " Support Screw
264229	15794	Take-up Lever
264629	15794	" " Driving Stud with 202277
202277	15794	" " " " Oil Packing (wick)
202400	15794	Take-up Lever Hinge Stud with 202423
202423	15794	" " " " Oil Packing (wick)
200383C	15794	Take-up Lever Hinge Stud Set Screw
264230	15796	Tension Bracket with 264231 and 350518C
200159F	15796	Tension Bracket Screw
264231	15796	" " Thread Guide Pin
264232	15796	Tension Bracket complete, Nos. 200978H, 201572H, 223703, 223706, 264230, 264235, 350519C, two each 1560C, 32572, 200309E, 223438, 223704 and four 2102
2102	15796	Tension Disc
223703	15796	" Release Lever
264233	15795	" " " Rod
200309E	15796	" " " Screw
223704	15796	" " Plunger
240141	15795	" " Slide
240142	15795	" " " Spring
32572	15796	" " Washer
223438	15796	" Spring
350518C	15796	" Stud
1560C	15796	" Thumb Nut
223706	15796	Thread Controller Disc
200978H	15796	" " " Screw
264235	15796	" " Spring
241360	15796	" " " Stop

No.	Plate	Name
200132E	15796	Thread Controller Spring Stop Screw
350519C	15796	" " Stud with 204925
200061C	15796	" " " Set Screw
201572H	15796	" " " Thumb Nut
204925	15796	" " " Washer
224028	15790	" Guide
224040	15796	" Guide
210955	15796	" " (upper)
200582H	15796	" " Screw (3)
241755	15797	" Lubricator Oil Pad (felt)
237779	15797	" " " " Holder
240439	15797	" " " " Retainer
241758	15797	" " " Reservoir
241759	15797	" " " Wick
264236	15797	" " Position Bracket
200113F	15797	" " " "
		Screw
350432XC	15797	Thread Lubricator Screw
201650H	15797	" " " Nut
214838	15797	" " " Washer
237780	15797	Thread Lubricator complete, Nos. 214838, 237779, 240439, 241755, 241758 and 241759
240034	15796	Thread Retainer (2)
200366H	15796	" " Set Screw (2)
264237	15793	Throat Plate, for 264210, in gauges 3/16, 7/32 and 1/4 inch
264238	15793	Throat Plate, for 264211, in gauges 9/32, 5/16, 11/32, 3/8 and 13/32 inch
200577AL	15793	Throat Plate Screw (2)
240183	15795	Vibrating Presser Bar
240184	15795	" " " Connecting Link
240185	15795	" " " Extension with 204264 and 240186
240186	15795	Vibrating Presser Bar Extension Collar
204264	15795	Vibrating Presser Bar Extension Collar Pin
202277	15795	Vibrating Presser Bar Oil Packing (wick)
240188	15795	Vibrating Presser Bar Spring
350299C	15795	" " " Thumb Screw (pressure regulating)
264241	15795	Vibrating Presser Foot, 30 needle hole, in gauges from 3/16 to 13/32 in., in steps of 1/32 in.; with 200086F, for 264224
200086F	15795	Vibrating Presser Foot Pinch Screw

ACCESSORIES

No.	Plate	Name
233939	15791	Bobbin (10)
228476	16063	Screw Driver (Bobbin Case)
135x20	-----	Needles, twelve, size 25
224121	16644	Drip Pan, 20 in. long, with four 3/4 in. wire nails
41400	16063	Machine Rest Pin (wood)
120342	16063	Oiler (copper plated) with 120343
120343	16063	" Spout (3-1/2 in. long)
11831	16063	Screw Driver (5 in. blade) (machine, large)
225498	16063	Screw Driver (7-1/4 in. long)
225554	16063	Wrench (steel)

BOBBIN WINDER

(SWINGING AUTOMATIC, RIGHT HAND)
FOR 5/16 INCH ROUND BELT DRIVE

259428	18312	Brake (leather)
259429	18312	" Clamp
200113F	18312	" " Screw
225453	18312	Frame with 202277 and 259660
225454	18312	" Hinge Pin
202277	18312	" Oil Packing (wick)
259660	18312	" " Well Washer
225455	18312	" Spring
225456	18312	" " Plunger
225368	18312	Pulley with 200380C
200380C	18312	" Set Screw
225381	18312	Spindle
225444	18312	Stop Latch
200056E	18312	" " Screw
225458	18312	" " Thumb Lever
225459	18312	" " " " Hinge Stud
225459	18312	" " " " Joint Stud
202478	18312	" " Trip Lever
200299H	18312	" " " " Hinge Screw
225461	18312	Tension Bracket with 201499H
200082D	18312	" " Screw
228026	18312	" " " Washer
2102	18312	" Disc
13710	18312	" Spring
201499H	18312	" Stud
201572H	18312	" " Thumb Nut
225462	18312	Bobbin Winder Tension Bracket complete, Nos. 13710, 201572H, 225461 and two 2102

ACCESSORIES

15

No.	Plate	Name
259430	18312	Bobbin Winder and Tension Bracket Base
259431	18312	Universal Bobbin Winder complete, Nos. 200056E, 200082D, 200113F, 200299H, 202478, 225368, 225381, 225444, 225453 to 225456, 225458, 225462, 228026, 259428 to 259430, two each 225459 and wood screws 3/4 in., No. 12, R. H. B.

KNEE LIFTER

228359	16643	Rock Lever with two 350231C
228486	16643	" " Bracket with 200347C and three wood screws 7/8 in., No. 12
228361	16643	Rock Lever Bracket 228486 with 228359, 228363, 228367, 228386 and 228455
228362	16643	Rock Lever Extension with 200529C
350231C	16643	" " " Set Screw
228363	16643	" " Hinge Pin
228364	16643	" " Knee Plate with 350231C
228388	16643	" " " " Arm
350231C	16643	" " " " " Set Screw
350231C	16643	" " " " " Set Screw
228455	16643	" " Position Spring
228365	16643	" " Rod
200529C	16643	" " " Set Screw
228386	16643	" " Spring
228367	16643	" " Stop Stud
200347C	16643	" " " " " Set Screw
228368	16643	Knee Lifter complete, Nos. 228361, 228362, 228364, 228365 and 228388

(Other Knee Lifter Parts are listed with parts of Machine Head)

THREAD UNWINDER

FOR THREE SPOOLS

228692	16257	Spool Pin
201528H	16257	" " Nut
228693	16257	" " Washer
225259	16257	" Rest (for one spool) (flat) with 201018C, 201528H, 228692 and 228693
225257	16257	Spool Rest (for two spools) (flat) with 201018C, two each 201528H, 228692 and 228693
150203	16257	Spool Rest Cushion (felt)

ACCESSORIES

No.	Plate	Name
225388	16257	Spool Rest Rod
200383C	16257	" " " Set Screw
201018C	16257	" " Set Screw
259658	16257	" Stand with 200383C
225391	16257	Thread Guide
201696H	16257	" " Lock Nut
225326	16257	" " Position Cup
225324	16257	" " Rod with 208AL and 225322
208AL	16257	Thread Guide Rod Screw
225322	16257	" " " Washer
259143	16257	Thread Unwinder (for three spools) complete, Nos. 201696H, 225257, 225259, 225324, 225326, 225388, 259658, three each 150203, 225391 and wood screws 7/8 in., No. 12

BOBBIN WINDER

(SWINGING AUTOMATIC, RIGHT HAND)
FOR "V" BELT DRIVE

259461	18312	Pulley with 200380C
259662	18312	Bobbin Winder and Tension Bracket Base
259462	18312	Universal Bobbin Winder complete, Nos. 200056E, 200082D, 200113F, 200299H, 202478, 225381, 225444, 225453 to 225456, 225458, 225462, 228026, 259428, 259429, 259461, 259662, two each 225459 and wood screws 3/4 in., No. 12, R. H. B.

FOOT LIFTER

PARTS REQUIRED FOR CHANGING FROM
KNEE LIFTER TO FOOT LIFTER

223733	15798	Foot Lifter Lifting Lever Extension
200082D	15798	" " " " "
		Screw (2)
227561	15798	Foot Lifter Lifting Lever Spring
200835D	15798	" " " " " Stop Screw

FOOT LIFTER

227952	15798	Lever with 227954
227678	15798	" Chain, 48 in. long, with 202784

No.	Plate	Name
227954	15798	Lever Chain Hook (lower)
202784	15798	" " " (upper)
225016	15798	" Hinge Pin
227939	15798	" Stand with two wood screws lin., No. 12
227955	15798	Foot Lifter Lever complete, Nos. 225016, 227678, 227939 and 227952

MISCELLANEOUS PARTS

USED IN CONJUNCTION WITH THREAD UNWINDER

60913	16257	Spool Weight with 60914
60914	16257	" " Center Pin
225377	16257	" Wire (for small spools)
27739	16257	Thread Cone (wood)
225390	16257	" " Holder

SINGER Needles should be used
in **SINGER** Machines
These Needles and their Containers
are marked with the
Company's Trade Mark "SIMANCO.***" ₁

Needles in Containers marked
"FOR SINGER MACHINES"
are NOT **SINGER** made needles. ₂



NUMERICAL LIST OF PARTS

No.	Plate	Name
208AL	16257	Thread Unwinder Thread Guide Rod Screw, for 225324
217D	17258	Lifting Eccentric Set Screw, for 237196
443C	17258	" " Body Set Screw, for 237196
1103C	17258	Lifting Eccentric Regulating Screw, for 237196
1560C	15796	Tension Thumb Nut, for 264232
2102	18312	Bobbin Winder Tension Disc, for 225462
2102	15796	Tension Disc, for 264232
7071	17258	Lifting Eccentric Set Screw Washer, for 237196
11831	16063	Screw Driver (5 in. blade) (machine large)
13710	18312	Bobbin Winder Tension Spring, for 225462
27739	16257	Thread Unwinder Thread Cone (wood)
32572	15796	Tension Release Washer, for 264232
41400	16063	Machine Rest Pin (wood)
54897	16053	Bed Oil Cup, for 264005
60913	16257	Thread Unwinder Spool Weight with 60914
60914	16257	Thread Unwinder Spool Weight Center Pin, for 60913
120342	16063	Oiler (copper plated) with 120343
120343	16063	" Spout (3-1/2 in. long) for 120342
150203	16257	Thread Unwinder Spool Rest Cushion (felt) for 259143
200004E	15797	Arm Base Screw
200004E	15797	" Screw
200008C	15792	Hook Post Screw
200019E	16054	Feed Driving Rock Shaft Crank Pinch Screw, for 223652
200024C	15793	Feed Dog Lever Post Screw
200029E	17258	Lifting Eccentric Connection Crank Pinch Screw, for 240171
200029E	17258	Needle Bar Rock Frame Rock Shaft Crank Pinch Screw, for 264112
200040C	16054	Feed Lifting Cam Fork Screw, for 264007
200049D	16052	Feed Driving Connection Pinch Screw, for 264008
200054E	15795	Presser Bar Lifting Bracket Pinch Screw, for 208555
200056E	18312	Bobbin Winder Stop Latch Screw, for 259431 and 259462
200061C	15796	Thread Controller Stud Set Screw
200074F	15795	Lifting Presser Foot Screw, for 208566

NUMERICAL LIST OF PARTS

No.	Plate	Name
200082D	18312	Bobbin Winder Tension Bracket Screw, for 259431 and 259462
200082D	15798	Foot Lifter Lifting Lever Extension Screw
200086C	15794	Needle Bar Connecting Stud Pinch Screw, for 208552
200086F	15795	Presser Bar Position Guide Lever Pinch Screw, for 202338
200086C	15795	Presser Bar Spring Bracket Pinch Screw, for 210949
200086F	15795	Vibrating Presser Foot Pinch Screw, for 264241
200096D	16053	Bed Oil Guard Screw
200098E	15793	Feed Dog Lever Retainer Washer Screw, for 264033
200098E	15793	Feed Dog Screw
200098F	15794	Needle Bar Rock Frame Position Bracket Screw
200113F	16053	Arm Shaft Connection Belt Timing Collar Set Screw, for 224113
200113F	18312	Bobbin Winder Brake Clamp Screw, for 259431 and 259462
200113F	15797	Thread Lubricator Position Bracket Screw
200126D	15792	Bobbin Case Lever Driving Block Screw, for 264219
200132E	15793	Feed Dog Lever Post Oil Guard Screw
200132E	15796	Thread Controller Spring Stop Screw
200138D	15792	Hook Post Oil Packing (wick) Screw, for 264219
200141F	15794	Needle Set Screw, for 264226
200159F	15793	Hook Post Clamping Screw
200159F	15796	Tension Bracket Screw
200164B	16053	Arm Shaft Connection Belt Timing Plate Screw
200173D	16054	Feed Lifting Cam Oiling Felt Screw, for 224052
200256C	16052	Feed Driving Eccentric Regulating Bracket Hinge Screw, for 224107
200256C	16052	Feed Driving Eccentric Regulating Bracket Stop Screw, for 224107
200262H	15797	Knee Lifter Connection Lever Hinge Screw
200262H	15797	Knee Lifter Lifting Lever Hinge Screw
200263D	15793	Feed Dog Lever Hinge Screw
200278H	15790	Arm Cap Screw
200299H	18312	Bobbin Winder Stop Latch Trip Lever Hinge Screw, for 259431 and 259462
200309E	15796	Tension Release Lever Screw, for 264232
200327C	16052	Arm Shaft Connection Belt Pulley Set Screw, for 224104
200327C	16053	Hook Driving Shaft Bushing (back) Set Screw
200327C	16053	Hook Driving Shaft Bushing (front) Set Screw

NUMERICAL LIST OF PARTS

21

No.	Plate	Name
200335C	16053	Hook Driving Shaft Bushing (center) Set Screw
200335C	15794	Needle Bar Crank Set Screw, for 202692
200338C	15790	Arm Shaft Bushing (back) Set Screw
200338C	15790	" " " (front) Set Screw
200338C	15790	Balance Wheel Set Screw, for 237577
200347C	16643	Knee Lifter Rock Lever Stop Stud Set Screw, for 228486
200347C	15794	Needle Bar Rock Frame Hinge Stud Set Screw
200352C	15795	Presser Bar Bushing Set Screw
200352C	15795	" " Position Guide Set Screw
200362C	16053	Hook Driving Gear Set Screw, for 223867
200366H	15796	Thread Retainer Set Screw
200374C	15794	Needle Bar Connecting Link Stud Set Screw, for 202692
200380C	18312	Bobbin Winder Pulley Set Screw, for 225368 and 259461
200382C	15792	Hook Socket Gear Set Screw, for 224021
200383C	16257	Thread Unwinder Spool Rest Rod Set Screw, for 259658
200383C	16052	Feed Driving Eccentric Regulating Bracket Flange Set Screw, for 224108
200383C	16052	Feed Driving Eccentric Regulating Screw Check Screw
200383C	16054	Feed Driving Rock Shaft Stop Collar Set Screw, for 202625
200383C	15794	Needle Bar Connecting Link Stud Set Screw, for 202692
200383C	15794	Take-up Lever Hinge Stud Set Screw
200387C	17258	Needle Bar Rock Frame Slide Block Screw Stud Set Screw, for 223691
200428C	15794	Needle Bar Crank Position Screw, for 202692
200429C	16052	Feed Driving Eccentric Regulating Screw
200437C	16052	Feed Driving Eccentric Regulating Bracket Flange Position Screw, for 224108
200473H	15797	Face Plate Thumb Screw
200502H	15790	Arm Shaft Bushing (front) Oil Packing Thumb Screw
200529C	16643	Knee Lifter Rock Lever Rod Set Screw, for 228362
200555H	15792	Hook Socket Screw, for 264219
200570E	16052	Bed Hinge Connection Screw
200577AL	15793	Throat Plate Screw
200582H	15796	Thread Guide Screw
200583H	15792	Hook Post Cover Plate Screw, for 264220 and 264221
200594C	15791	Bobbin Case Tension Spring Screw, for 264204
200602C	16052	Arm Shaft Connection Belt Pulley Position Screw, for 224104
200607C	16052	Feed Driving Eccentric Regulating Bracket Plunger Spring Stop Screw

NUMERICAL LIST OF PARTS

No.	Plate	Name
200653C	15795	Presser Bar Lifter Hinge Screw
200833C	16052	Needle Bar Rock Frame Rock Shaft Crank Connection Hinge Screw
200835D	15798	Foot Lifter Lifting Lever Spring Stop Screw
200943F	15793	Feed Dog Lever Slide Block Hinge Screw, for 264033
200948F	15797	Presser Bar Spring Support Screw
200975F	15795	" " Lifting Bracket Guide Screw
200978H	15796	Thread Controller Disc Screw, for 264232
200984C	15791	Bobbin Case Tension Spring Regulating Screw, for 264204
200996C	15795	Lifting Bell Crank Cap Screw
201018C	16257	Thread Unwinder Spool Rest Set Screw, for 225257 and 225259
201141C	17258	Needle Bar Rock Frame Slide Block Screw Stud, for 210920
201171C	16052	Feed Driving Connection Hinge Screw
201183D	15794	Needle Bar Connecting Link Oil Guard Screw
201220C	16053	Feed Lifting Cam Set Screw, for 224154
201222C	16053	Hook Driving Gear Position Screw, for 223867
201253F	15791	Hook Gib Screw, for 264215
201254C	16053	" Driving Shaft Connection Belt Pulley Set Screw, for 224112
201272C	15792	Bobbin Case Lever Hinge Screw, for 264219
201370D	15792	Bobbin Case Lever Driving Block Swivel Hinge Screw, for 264219
201376C	15791	Hook Gib Hinge Screw, for 264215
201410F	15797	Presser Bar Spring Regulating Screw
201499H	18312	Bobbin Winder Tension Stud, for 225461
201517E	16052	Feed Driving Connection Hinge Screw Nut
201518E	16054	Feed Bar Hinge Screw Nut, for 264009
201522E	16052	Needle Bar Rock Frame Rock Shaft Crank Connection Hinge Screw Nut
201524E	17258	Lifting Bell Crank Link Screw Stud Nut, for 240136
201525E	15793	Feed Dog Lever Slide Block Hinge Screw Nut, for 264033
201525E	16052	Feed Driving Eccentric Regulating Bracket Hinge Screw Nut, for 224107
201525E	16052	Feed Driving Eccentric Regulating Bracket Stop Screw Nut, for 224107
201528D	15793	Feed Dog Lever Hinge Screw Nut
201528H	16257	Thread Unwinder Spool Pin Nut, for 225257 and 225259
201572H	18312	Bobbin Winder Tension Stud Thumb Nut, for 225462
201572H	15796	Thread Controller Stud Thumb Nut, for 264232
201650H	15797	Thread Lubricator Screw Nut, for 240179

NUMERICAL LIST OF PARTS

23

No.	Plate	Name
201696H	16257	Thread Unwinder Thread Guide Lock Nut, for 259143
202005	15797	Arm Base Screw Washer
202005	15797	" Screw Washer
*202056	-----	Bobbin Case Base Latch Pin, for 264203
202135	15797	Face Plate Position Pin, for 264201
202244	15790	Arm Shaft Bushing (back) Oil Packing (wick), for 240802
202244	15790	Arm Shaft Bushing (front) Oil Packing (wick), for 207080
202244	16053	Hook Driving Shaft Bushing (back) Oil Packing (wick) for 224111
202248	15790	Arm Cap Screw Washer
202253	16052	" Shaft Connection Belt Pulley Spring Flange, for 224104
202253	16053	Hook Driving Shaft Connection Belt Pulley Spring Flange, for 224112
202254	15794	Needle Bar Connecting Link Stud Oil Packing (wick) for 202333
202258	16052	Bed Hinge Connection
202277	18312	Bobbin Winder Frame Oil Packing (wick) for 225453
202277	16052	Feed Driving Connection Hinge Screw Oil Packing (wick)
202277	16052	Feed Driving Connection Oil Packing (wick) for 264008
202277	15794	Needle Bar Rock Frame Hinge Stud Oil Packing (wick) for 210910
202277	16052	Needle Bar Rock Frame Rock Shaft Crank Connection Oil Packing (wick) for 264052
202277	15794	Take-up Lever Driving Stud Oil Packing (wick) for 264629
202277	15795	Vibrating Presser Bar Oil Packing (wick)
202300	16052	Feed Driving Eccentric Regulating Bracket, for 224107
202302	15797	Knee Lifter Connection Lever Lifting Rod Cotter Pin, for 264051
*202311	-----	Feed Regulating Spindle Head, for 224122
202330	15794	Needle Bar Connecting Stud Oil Packing (wick) for 208552
202333	15794	Needle Bar Connecting Link Stud with 202254, for 202692
202337	15795	Presser Bar Position Guide
202338	15795	" " " " Lever with 200086F
202400	15794	Take-up Lever Hinge Stud with 202423, for 264228
202423	15794	Take-up Lever Hinge Stud Oil Packing (wick) for 202400
202443	15790	Feed Regulating Spindle Head Pin, for 224122
202478	18312	Bobbin Winder Stop Latch Trip Lever, for 259431 and 259462

NUMERICAL LIST OF PARTS

No.	Plate	Name
202619	15790	Feed Regulating Spindle Head Position Pin, for 224122
202625	16054	Feed Driving Rock Shaft Stop Collar with two 200383C
202666	15794	Needle Bar Rock Frame Position Bracket
202668	17258	Needle Bar Rock Frame Slide Block, for 210920
202671	15795	Presser Bar Lifter
202692	15794	Needle Bar Crank with 200335C, 200374C, 200383C, 200428C and 202333, for 264228
202784	15798	Foot Lifter Lever Chain Hook (upper) for 227678
203172	15794	Needle Bar Crank Friction Washer Nos. 203211 to 203213, for 264203
203211	15791	Bobbin Case Base Latch
203212	15791	" " " " Plunger
203213	15791	" " " " Spring
203216	15791	" " Washer (cloth) for 264203
203377	15791	" " Tension Spring, for 264204
203624	15793	Feed Dog Lever Retainer Washer, for 264033
203637	15793	Feed Dog Lever Post Screw Washer
203637	15792	Hook Post Screw Washer
203718	15791	" Washer, for 264219
204235	15797	Arm Base Position Pin
204235	15797	" Position Pin
204264	15795	Vibrating Presser Bar Extension Collar Pin, for 240185
204925	15796	Thread Controller Stud Washer, for 350519C
207072	15795	Presser Bar Bushing (upper)
207080	15790	Arm Shaft Bushing (front) with 202244
208552	15794	Needle Bar Connecting Stud with 200086C and 202330, for 264228
208555	15795	Presser Bar Lifting Bracket with 200054E
208566	15795	Presser Bar with 200074F
210910	15794	Needle Bar Rock Frame Hinge Stud with 202277
210920	17258	Needle Bar Rock Frame Slide Block 202668 with 201141C, for 223691
210949	15795	Presser Bar Spring Bracket with 200086C
210955	15796	Thread Guide (upper)
214838	15797	" Lubricator Screw Washer, for 237780
221209	15792	Hook Post Cover Plate (back) (inside) for machines in gauges from 9/16 to 3/4 inch
221215	15792	Hook Post Slide, for 264220 and 264221
223438	15796	Tension Spring, for 264232
223650	16054	Feed Driving Rock Shaft, for 264009
223652	16054	" " " " Crank with 200019E

NUMERICAL LIST OF PARTS

25

No.	Plate	Name
223655	16054	Feed Lifting Cam Oiling Felt, for 224052
223690	17258	Needle Bar Rock Frame Rock Shaft, for 223691
223691	17258	Needle Bar Rock Frame Rock Shaft 223690 with 200387C and 210920
223703	15796	Tension Release Lever, for 264232
223704	15796	" " Plunger, for 264232
223706	15796	Thread Controller Disc, for 264232
223733	15798	Foot Lifter Lifting Lever Extension
223814	16053	Bed Oil Guard Felt, for 264113
223867	16053	Hook Driving Gear (spiral) with 200362C and 201222C
224002	15790	Arm Cap
224021	15792	Hook Socket Gear with two 200382C, for 264219
224028	15790	Thread Guide
224040	15796	" Guide
224052	16054	Feed Lifting Cam Fork with 200173D and 223655, for 264007
224104	16052	Arm Shaft Connection Belt Pulley with 200327C, 200602C and two 202253
224107	16052	Feed Driving Eccentric Regulating Bracket 202300 with 224108, two each 200256C and 201525E
224108	16052	Feed Driving Eccentric Regulating Bracket Flange with 200383C and 200437C, for 224107
224110	16053	Hook Driving Shaft
224111	16053	" " " Bushing (back) with 202244
224112	16053	Hook Driving Shaft Connection Belt Pulley with 202253 and two 201254C
224113	16053	Arm Shaft Connection Belt Timing Collar with 200113F
224121	16644	Drip Pan, 20 in. long, with four 3/4 in. wire nails
224122	15790	Feed Regulating Spindle with 202311, 202443 and 202619
224139	16053	Arm Shaft Connection Belt Timing Plate
224154	16053	Feed Lifting Cam with 201220C
224392	15790	Arm Shaft Oil Packing (wick) for 264202
225016	15798	Foot Lifter Lever Hinge Pin, for 227955
225257	16257	Thread Unwinder Spool Rest (for two spools) (flat) with 201018C, two each 201528H, 228692 and 228693, for 259143
225259	16257	Thread Unwinder Spool Rest (for one spool) (flat) with 201018C, 201528H, 228692 and 228693, for 259143
225322	16257	Thread Unwinder Thread Guide Rod Washer, for 225324
225324	16257	Thread Unwinder Thread Guide Rod with 208AL and 225322, for 259143

NUMERICAL LIST OF PARTS

No.	Plate	Name
225326	16257	Thread Unwinder Thread Guide Position Cup, for 259143
225368	18312	Bobbin Winder Pulley with 200380C, for 259431
225377	16257	Thread Unwinder Spool Wire (for small spools)
225381	18312	Bobbin Winder Spindle, for 259431 and 259462
225388	16257	Thread Unwinder Spool Rest Rod, for 259143
225390	16257	Thread Unwinder Thread Cone Holder
225391	16257	" " " Guide, for 259143
225444	18312	Bobbin Winder Stop Latch, for 259431 and 259462
		Nos. 225453 to 225456, for 259431 and 259462
225453	18312	Bobbin Winder Frame with 202277 and 259660
225454	18312	Bobbin Winder Frame Hinge Pin
225455	18312	" " " Spring
225456	18312	" " " Plunger
225458	18312	" " Stop Latch Thumb Lever, for 259431 and 259462
225459	18312	Bobbin Winder Stop Latch Thumb Lever Hinge Stud, for 259431 and 259462
225459	18312	Bobbin Winder Stop Latch Thumb Lever Joint Stud, for 259431 and 259462
225461	18312	Bobbin Winder Tension Bracket with 201499H, for 225462
225462	18312	Bobbin Winder Tension Bracket complete, Nos. 13710, 201572H, 225461 and two 2102, for 259431 and 259462
225498	16063	Screw Driver (7-1/4 in. long)
225554	16063	Wrench (steel)
225837	16054	Feed Lifting Cam Fork Screw Washer, for 264007
227561	15798	Foot Lifter Lifting Lever Spring
227678	15798	" " Chain, 48 in. long, with 202784, for 227955
227939	15798	Foot Lifter Lever Stand with two wood screws 1 in., No. 12, for 227955
227952	15798	Foot Lifter Lever with 227954, for 227955
227954	15798	Foot Lifter Lever Chain Hook (lower) for 227952
227955	15798	Foot Lifter Lever complete, Nos. 225016, 227678, 227939 and 227952
228026	18312	Bobbin Winder Tension Bracket Screw Washer, for 259431 and 259462
228359	16643	Knee Lifter Rock Lever with two 350231C, for 228361
228361	16643	Knee Lifter Rock Lever Bracket 228486 with 228359, 228363, 228367, 228386 and 228455, for 228368
228362	16643	Knee Lifter Rock Lever Extension with 200529C, for 228368

NUMERICAL LIST OF PARTS

27

No.	Plate	Name
228363	16643	Knee Lifter Rock Lever Hinge Pin, for 228361
228364	16643	Knee Lifter Rock Lever Knee Plate with 350231C, for 228368
228365	16643	Knee Lifter Rock Lever Rod, for 228368
228367	16643	" " " " Stop Stud, for 228361
228368	16643	Knee Lifter complete, Nos. 228361, 228362, 228364, 228365 and 228388
228386	16643	Knee Lifter Rock Lever Spring, for 228361
228388	16643	Knee Lifter Rock Lever Knee Plate Arm, 228368
228455	16643	Knee Lifter Rock Lever Position Spring, for 228361
228476	16063	Screw Driver (Bobbin Case)
228486	16643	Knee Lifter Rock Lever Bracket with 200347C and three wood screws 7/8 in., No. 12, for 228361
228692	16257	Thread Unwinder Spool Pin, for 225257 and 225259
228693	16257	Thread Unwinder Spool Pin Washer, for 225257 and 225259
233939	15791	Bobbin
235871	15795	Presser Bar Bushing (lower)
237001	16052	Feed Driving Eccentric Regulating Bracket Plunger
237002	16052	Feed Driving Eccentric Regulating Bracket Plunger Spring
*237195	17258	Lifting Eccentric, for 237196
237196	17258	Lifting Eccentric complete, Nos. 217D, 443C, 1103C, 7071, 237195, 237749 and 350107C
237577	15790	Balance Wheel (belt groove 4 in. diam.) with two 200338C
*237749	17258	Lifting Eccentric Body, for 237196
237779	15797	Thread Lubricator Oil Pad Holder, for 237780
237780	15797	Thread Lubricator complete, Nos. 214838, 237779, 240439, 241755, 241758 and 241759
238251	15794	Needle Bar Connecting Link, for 264228
240034	15796	Thread Retainer
240125	17258	Lifting Bell Crank Link
240126	17258	" Eccentric Connection
240136	17258	" Rock Shaft with 201524E and 350172C
240138	15794	Needle Bar Rock Frame
240141	15795	Tension Release Slide
240142	15795	" " " Spring
240171	17258	Lifting Eccentric Connection Crank with 200029E and 248821
240172	15797	Presser Bar Spring (flat) (heavy)
240174	17258	Lifting Rock Shaft Bushing
240175	15797	Knee Lifter Lifting Lever
240179	15797	Face Plate with 201650H and 350432XC
240183	15795	Vibrating Presser Bar

NUMERICAL LIST OF PARTS

No.	Plate	Name
240184	15795	Vibrating Presser Bar Connecting Link
240185	15795	" " " Extension with 204264 and 240186
240186	15795	Vibrating Presser Bar Extension Collar, for 240185
240188	15795	Vibrating Presser Bar Spring
240205	15795	Lifting Bell Crank
240439	15797	Thread Lubricator Oil Pad Retainer, for 237780
240802	15790	Arm Shaft Bushing (back) with 202244
241360	15796	Thread Controller Spring Stop
241507	15792	Hook Post Cover Plate (back) (outside) for machines in gauges from 9/16 to 3/4 inch
241674	15791	Bobbin Case Oiling Felt, for 264204
241675	15791	" " " " Retainer, for 264204
241755	15797	Thread Lubricator Oil Pad (felt) for 237780
241758	15797	Thread Lubricator Oil Reservoir, for 237780
241759	15797	Thread Lubricator Oil Wick, for 237780
248821	17258	Lifting Eccentric Connection Crank Oil Packing (wick) for 240171
249072	15792	Hook Post Oil Packing (wick) for 264219
259143	16257	Thread Unwinder (for three spools) complete, Nos. 201696H, 225257, 225259, 225324, 225326, 225388, 259658, three each 150203, 225391 and wood screws 7/8 in., No. 12 Nos. 259428 to 259430, for 259431
259428	18312	Bobbin Winder Brake (leather) also for 259462
259429	18312	Bobbin Winder Brake Clamp, also for 259462
259430	18312	Bobbin Winder and Tension Bracket Base
259431	18312	Universal Bobbin Winder complete, Nos. 200056E, 200082D, 200113F, 200299H, 202478, 225368, 225381, 225444, 225453 to 225456, 225458, 225462, 228026, 259428 to 259430, two each 225459 and wood screws 3/4 in., No. 12, R. H. B.
259461	18312	Bobbin Winder Pulley with 200380C, used in place of 225368, for 259462
259462	18312	Universal Bobbin Winder complete (for "V" belt drives) Nos. 200056E, 200082D, 200113F, 200299H, 202478, 225381, 225444, 225453 to 225456, 225458, 225462, 228026, 259428, 259429, 259461, 259662, two each 225459 and wood screws 3/4 in., No. 12, R. H. B., used in place of 259431
259658	16257	Thread Unwinder Spool Stand with 200383C, for 259143

NUMERICAL LIST OF PARTS

29

No.	Plate	Name
259660	18312	Bobbin Winder Frame Oil Well Washer, for 225453
259662	18312	Bobbin Winder and Tension Bracket Base, used in place of 259430, for 259462
264002	-----	Arm Base
264004	16052	" Shaft Connection Belt
*264005	-----	Bed with 54897
264006	16054	Feed Bar, for 264007
264007	16054	" " 264006 with 200040C, 224052 and 225837, for 264009
264008	16052	Feed Driving Connection with 200049D and 202277
264009	16054	Feed Driving Rock Shaft 223650 with 201518E, 264007 and 350393C
264031	15793	Feed Dog Lever, for 264033
264032	15793	" " " Post, for 264033
264033	15793	" " " " 264032 with 200943F, 201525E, 203624, 264031, 264035 and two 200098E
264034	15793	Feed Dog Lever Post Oil Guard
264035	15793	" " " Slide Block, for 264033
264038	16053	Hook Driving Shaft Bushing (center)
264039	16053	" " " " (front)
264044	15792	" Post Cover Plate (back) (inside) for machines in gauges from 3/16 to 17/32 in., for 264220
264045	15792	Hook Post Cover Plate (back) (outside) for machines in gauges from 3/16 to 17/32 in., for 264221
264046	15792	Hook Post Cover Plate (front) (inside) for machines in gauges from 3/16 to 17/32 in., for 264220
264047	15792	Hook Post Cover Plate (front) (outside) for machines in gauges from 3/16 to to 17/32 in., for 264221
264048	15792	Hook Post Cover Plate Gasket, for 264220 and 264221
264050	15797	Knee Lifter Connection Lever
264051	15797	" " " " Lifting Rod with 202302
264052	16052	Needle Bar Rock Frame Rock Shaft Crank Connection with 202277
264112	17258	Needle Bar Rock Frame Rock Shaft Crank with 200029E
264113	16053	Bed Oil Guard with 223814
264120	15792	Hook Post Cover Plate (front) (outside) for machines in gauges from 9/16 to 3/4 inch
264121	15792	Hook Post Cover Plate (front) (inside) for machines in gauges from 9/16 to 3/4 inch
264156	15792	Hook Socket, for 264219
*264201	-----	Arm with 202135
264202	15790	" Shaft with 224392 and 350431E
264203	15791	Bobbin Case Base (eccentric) with 202056, 203211 to 203213 and 203216, for 264209

NUMERICAL LIST OF PARTS

No.	Plate	Name
264204	15791	Bobbin Case Cap with 200594C, 200984C, 203377, 241674, 241675 and two 350405C, for 264209
		Nos. 264205 to 264207, for 264219
264205	15792	Bobbin Case Lever
264206	15792	" " " Driving Block
264207	15792	" " " " " Swivel
264209	15791	Bobbin Case complete, Nos. 264203 and 264204, for 264216
264210	15793	Feed Dog, 30 needle hole, for needle sizes 25 and 26, in 3/16, 7/32 and 1/4 in. gauge, for 264237
264211	15793	Feed Dog, 30 needle hole, for needle sizes 25 and 26, in 9/32, 5/16, 11/32, 3/8 and 13/32 in. gauge, for 264238
*264214	-----	Hook (sewing) for 264215
264215	15791	" 264214 with 201253F, 201376C and 264217, for 264216
264216	15791	Hook and Bobbin Case complete, Nos. 264209 and 264215, for 264219
264217	15791	Hook Gib, for 264215
264218	15792	" Post, for 264219
264219	15792	" " 264218 with 200555H, 201272C, 201370D, 203718, 224021, 249072, 264156, 264205 to 264207, 264216, two each 200126D and 200138D, for 264220 and 264221
264220	15792	Hook Post 264219 with 221215, 264044, 264046, two 264048 and eight 200583H
264221	15792	Hook Post 264219 with 221215, 264045, 264047, two 264048 and eight 200583H
264224	15795	Lifting Presser Foot, in gauges from 3/16 to 13/32 in., in steps of 1/32 in., for 264241
264226	15794	Needle Bar and Holder, in gauges from 3/16 to 5/8 in., in steps of 1/32 in., with two 200141F
264228	15794	Needle Bar Crank 202692 with 202400, 208552, 238251, 264229 and 264629
264229	15794	Take-up Lever, for 264228
264230	15796	Tension Bracket with 264231 and 350518C, for 264232
264231	15796	Tension Bracket Thread, Guide Pin, for 264230
264232	15796	Tension Bracket complete, Nos. 200978H, 201572H, 223703, 223706, 264230, 264235, 350519C, two each 1560C, 32572, 200309E, 223438, 223704 and four 2102
264233	15795	Tension Release Lever Rod
264235	15796	Thread Controller Spring, for 264232
264236	15797	" Lubricator Position Bracket
264237	15793	Throat Plate, for 264210, in gauges 3/16, 7/32 and 1/4 inch
264238	15793	Throat Plate, for 264211, in gauges 9/32, 5/16, 11/32, 3/8 and 13/32 inch

NUMERICAL LIST OF PARTS

31

No.	Plate	Name
264241	15795	Vibrating Presser Foot, 30 needle hole, in gauges from 3/16 to 13/32 in., in steps of 1/32 in., with 200086F, for 264224
264629	15794	Take-up Lever Driving Stud with 202277, for 264228
264718	15794	Needle Bar Connecting Link Oil Guard
350107C	17258	Lifting Eccentric Body Position Screw, for 237196
350172C	17258	Lifting Bell Crank Link Screw Stud, for 240136
350231C	16643	Knee Lifter Rock Lever Extension Set Screw, for 228359
350231C	16643	Knee Lifter Rock Lever Knee Plate Arm Set Screw, for 228359
350231C	16643	Knee Lifter Rock Lever Knee Plate Set Screw, for 228364
350299C	15795	Vibrating Presser Bar Thumb Screw (pressure regulating)
350393C	16054	Feed Bar Hinge Screw (driving) for 264009
350405C	15791	Bobbin Case Oiling Felt Retainer Screw, for 264204
350431E	15790	Arm Shaft Oil Packing Stop Screw, for 264202
350432XC	15797	Thread Lubricator Screw, for 240179
350518C	15796	Tension Stud, for 264230
350519C	15796	Thread Controller Stud with 204925, for 264232

SINGER Needles should be used
in **SINGER** Machines
These Needles and their Containers
are marked with the
Company's Trade Mark "SIMANCO.***" 1

Needles in Containers marked
"FOR SINGER MACHINES"
are NOT **SINGER** made needles. 2

SINGER Needles should be used
in **SINGER** Machines
These Needles and their Containers
are marked with the
Company's Trade Mark "SIMANCO.**" 1

Needles in Containers marked
"FOR SINGER MACHINES"
are NOT **SINGER** made needles. 2

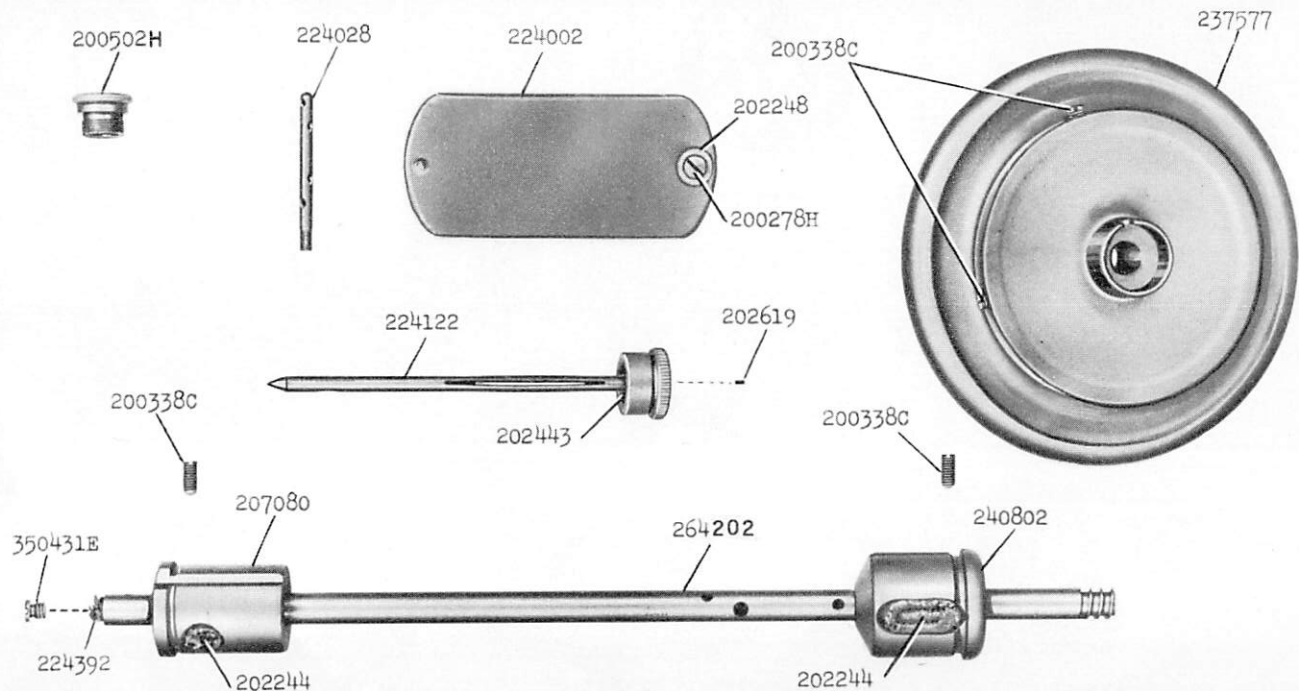

15790.1/3

From the library of: Superior Sewing Machine & Supply LLC

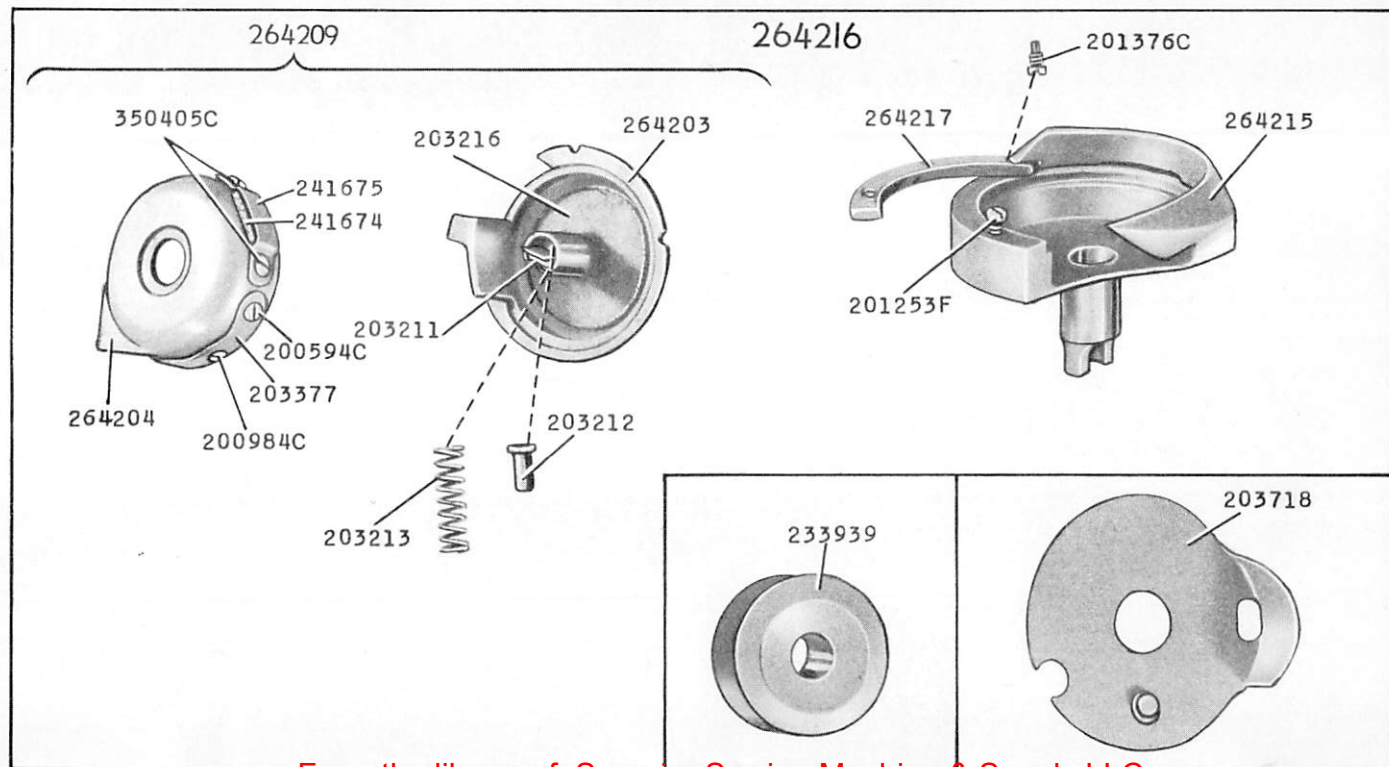

15791

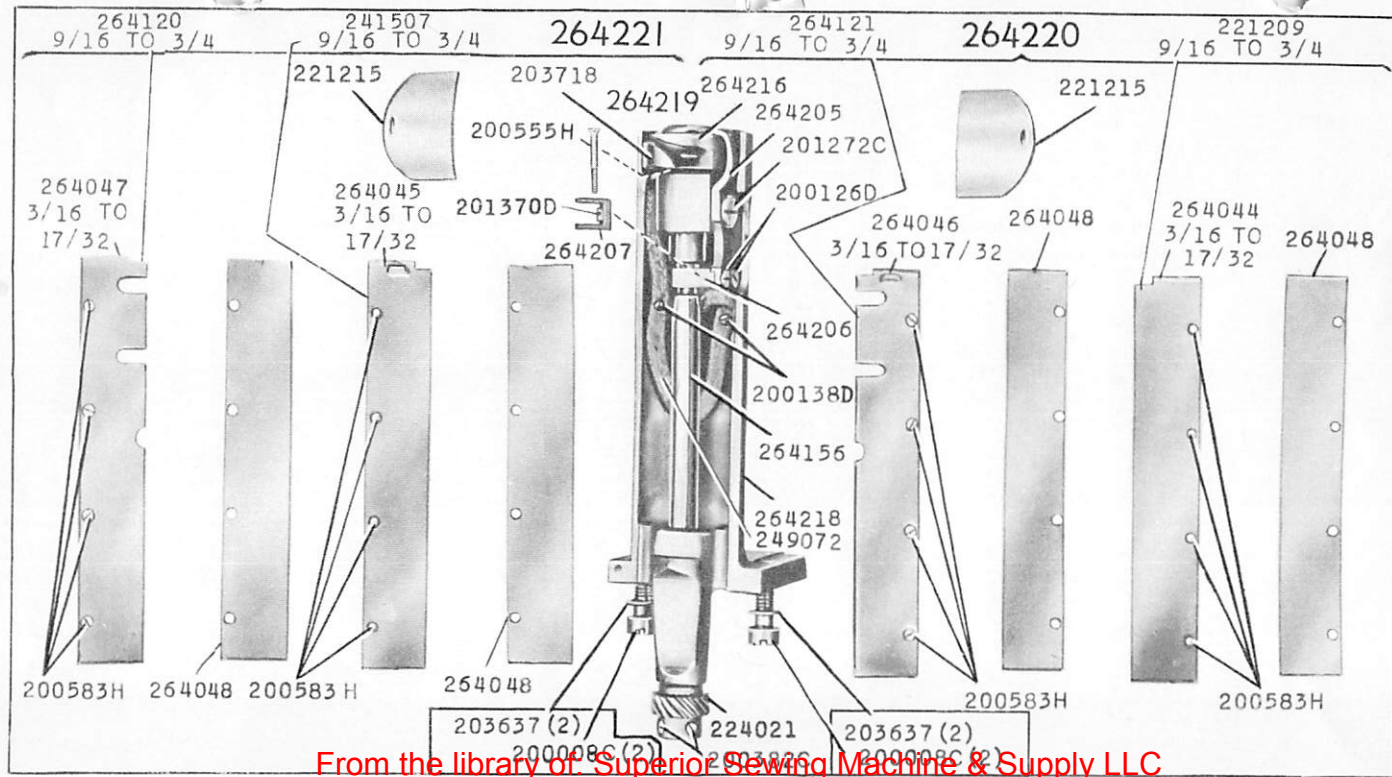

15792-1/3

264237-3/16-7/32-1/4
264238-9/32-5/16-11/32
3/8-13/32



200577AL



15-1

264210-3/16-7/32-1/4
264211-9/32-5/16-11/32
3/8-13/32

264033

264032

200098E

203624

201525E

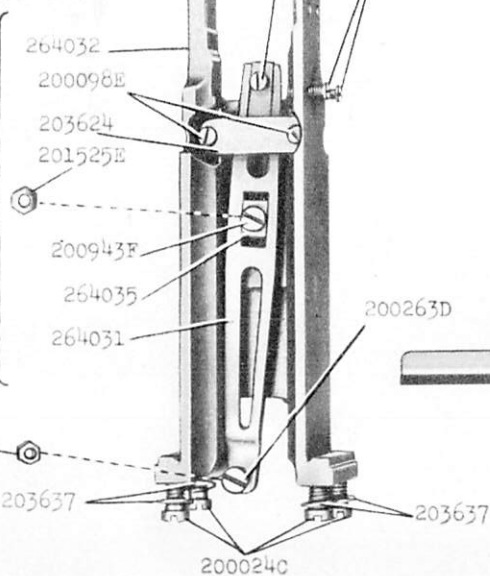

200943F

264035

264031

200098E

200159F

200263D

200024C

201528D

203637

203637

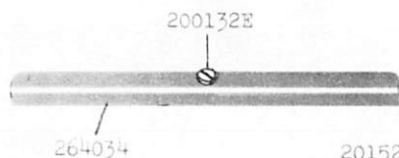

200132E

264034

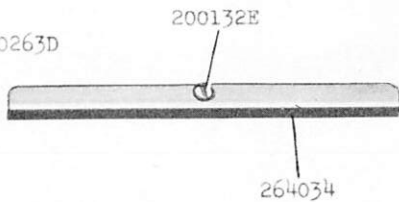

200132E

264034

15793-3/8

15794-1/2

264228

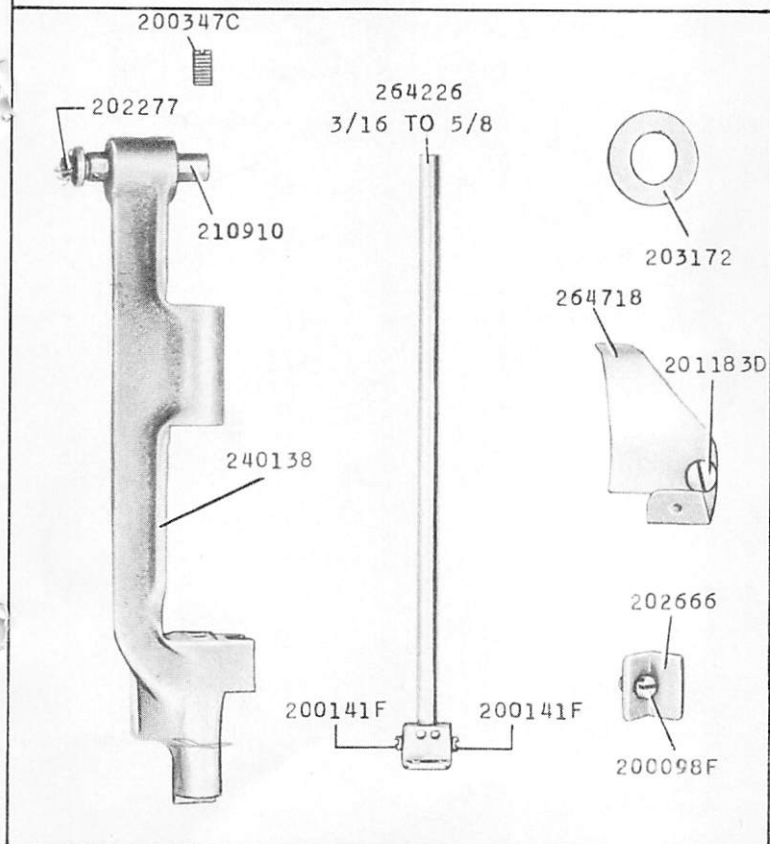
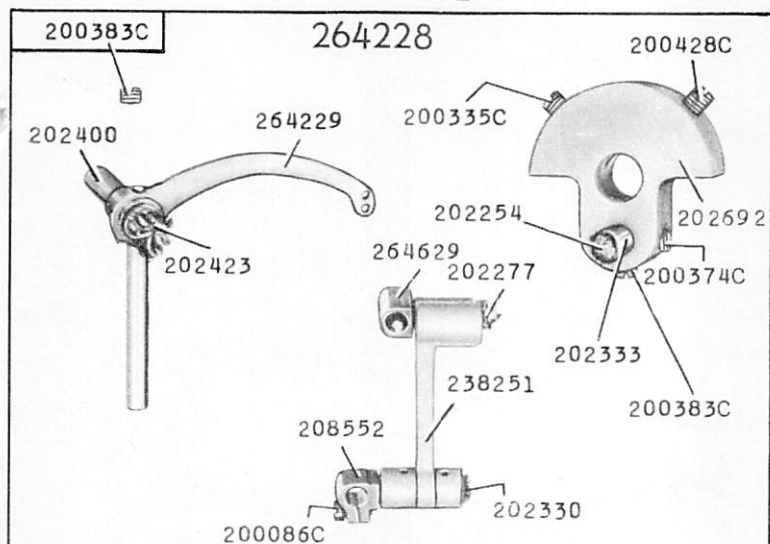

Exploded view diagram of a mechanical assembly, showing various components and their assembly sequence. The components are labeled with part numbers:

- 200352C
- 202337
- 207072
- 200352C
- 350299C
- 240205
- 200086F
- 202338
- 208566
- 240185
- 240186
- 204264
- 200975F
- 264233
- 208555
- 200054E
- 200996C
- 200653C
- 240184
- 240188
- 202277
- 240183
- 240142
- 235871
- 200352C
- 202671
- 240141
- 210949
- 200086C
- 200074F
- 264224
3/16 TO 13/32
- 264241
3/16 TO 13/32
- 200086F

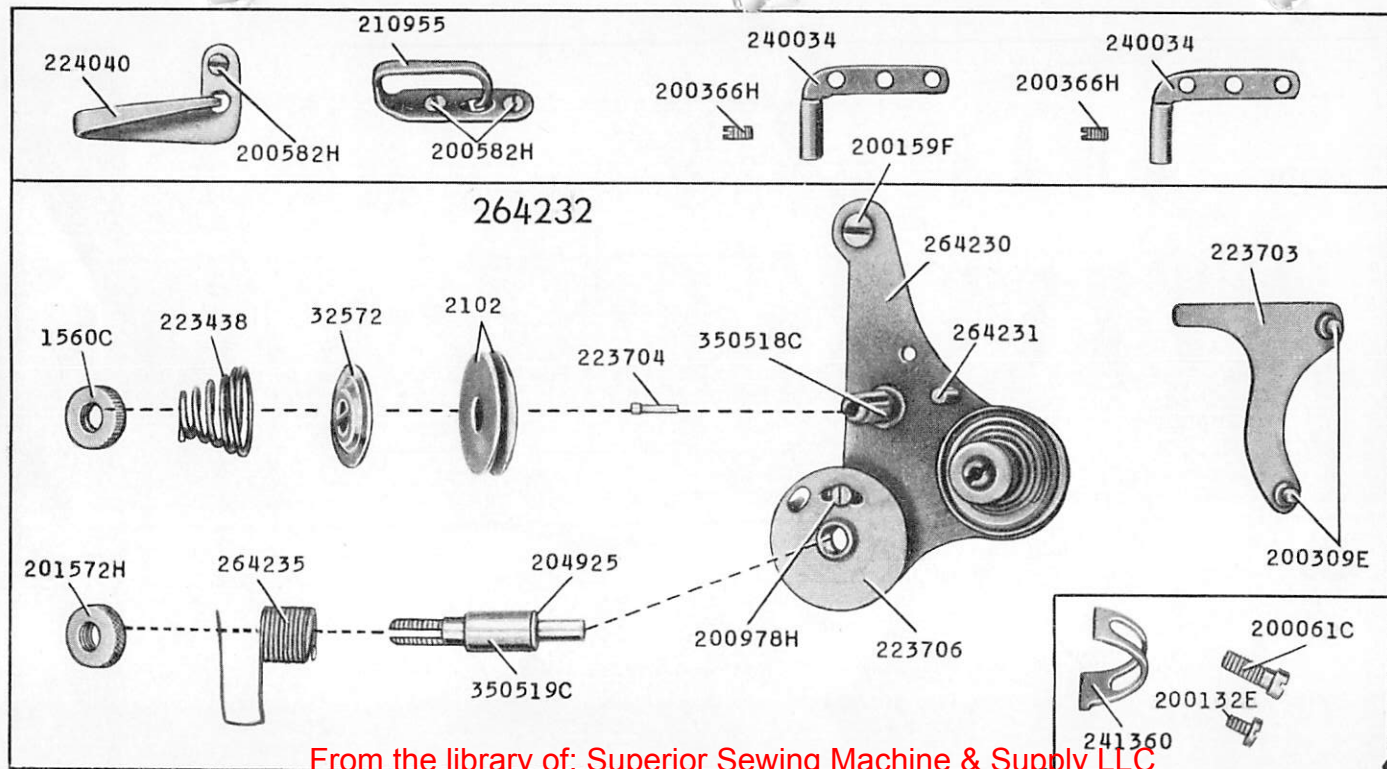

15796-2/3

From the library of: Superior Sewing Machine & Supply LLC

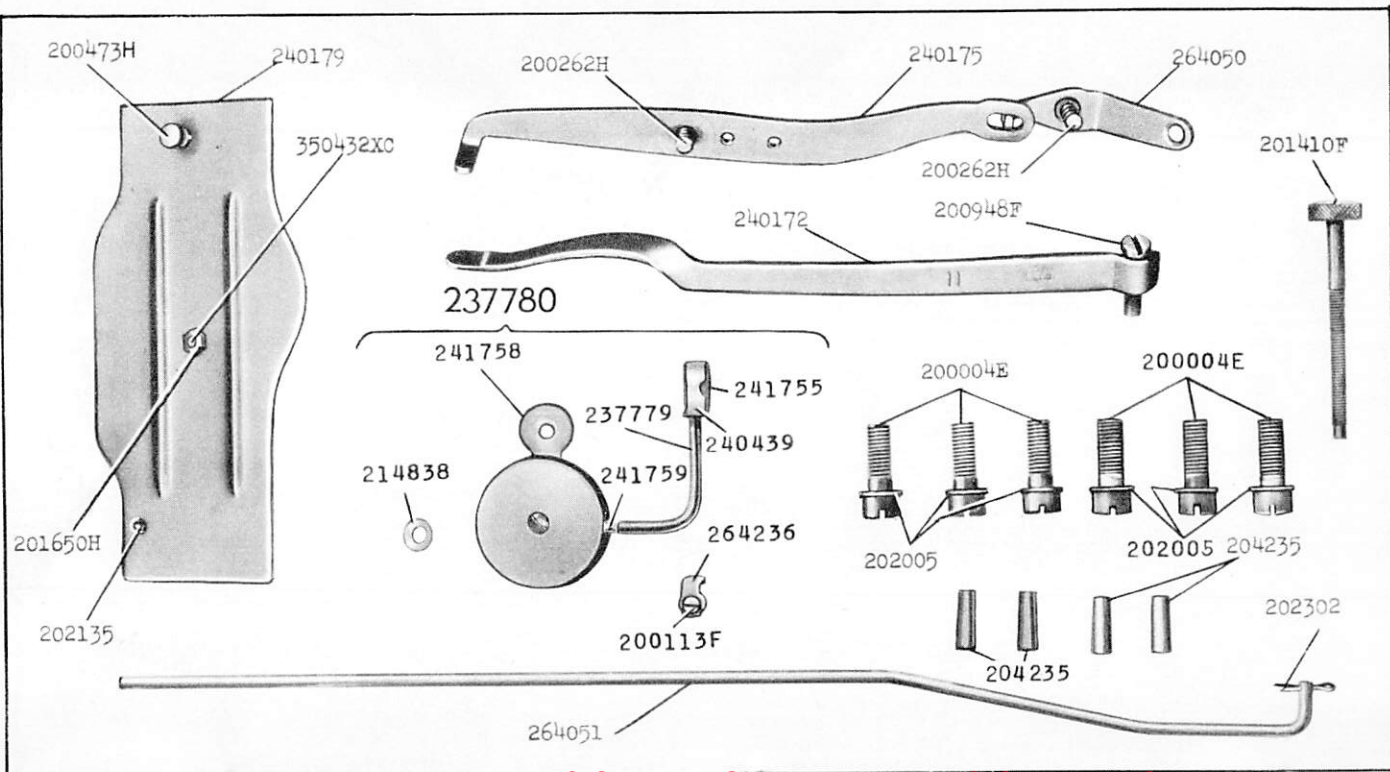

15797-3/8

202784

227955

227678-48"

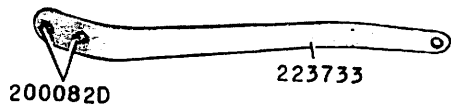
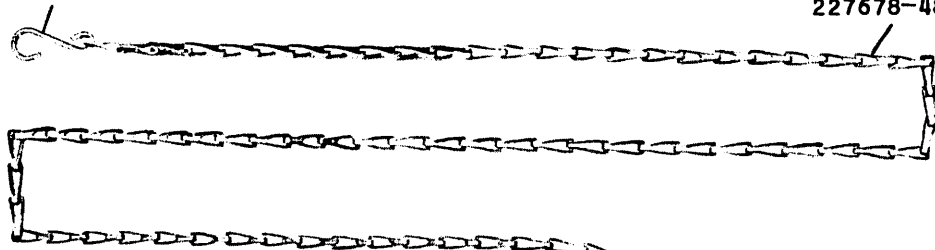

2000820

223733

2008350

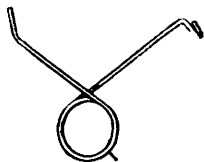

227561

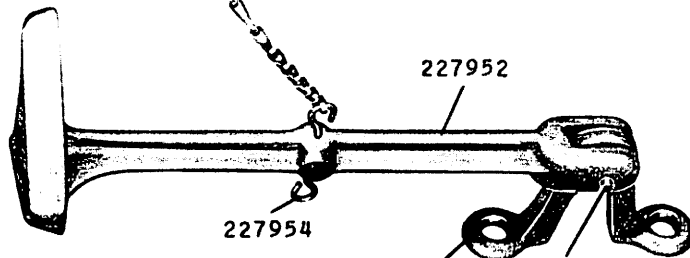

227952

227954

227939

225016

From the library of: Superior Sewing Machine & Supply LLC

15798-1/3

16052 - 1/3

224107

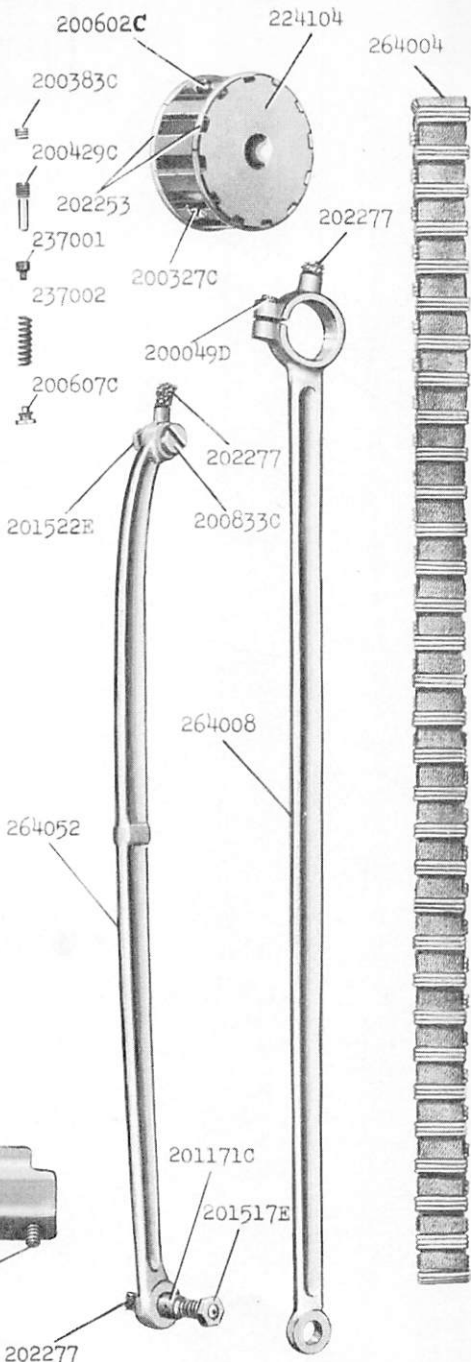
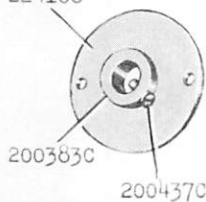
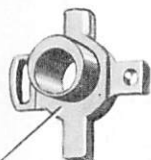
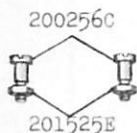

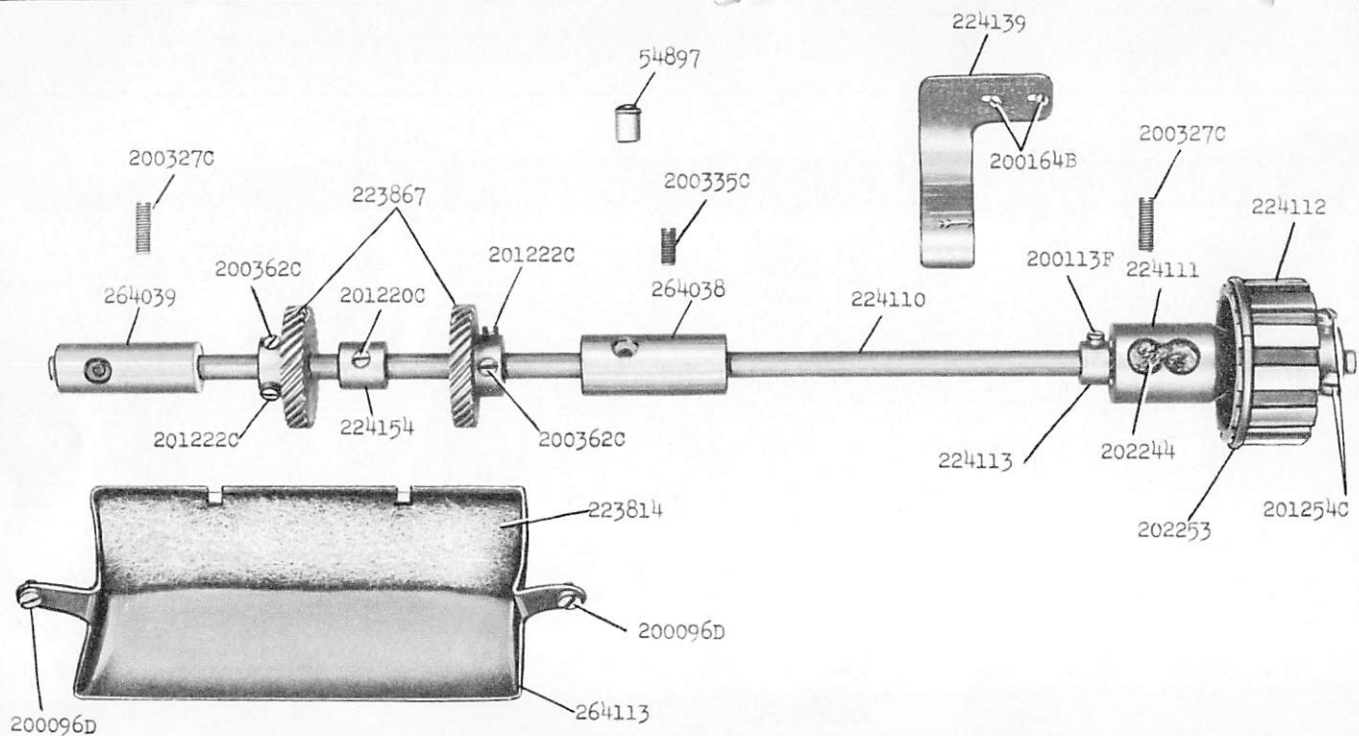

16053 - 3/8

From the library of: Superior Sewing Machine & Supply LLC

264009

264007

224052

225837

200040C

264006

223655

200173D

201518E

350393C

223650

200383C

202625

200383C

202625

200019E

223652

16054 - 1/2

From the library of: Superior Sewing Machine & Supply LLC

16063 - 1/2

120342

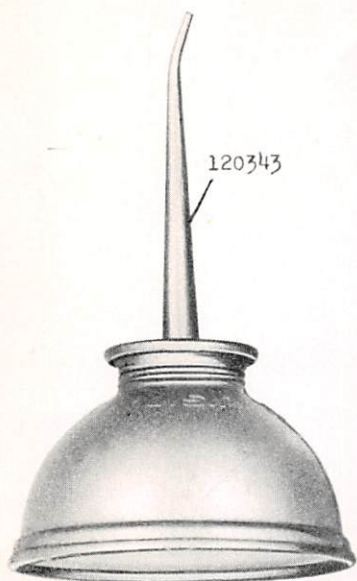

120343

225498



11831



228476



41400



225554



16257 - 1/6

259143

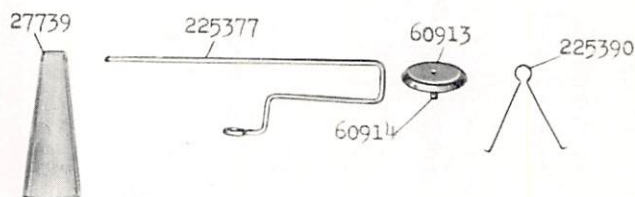
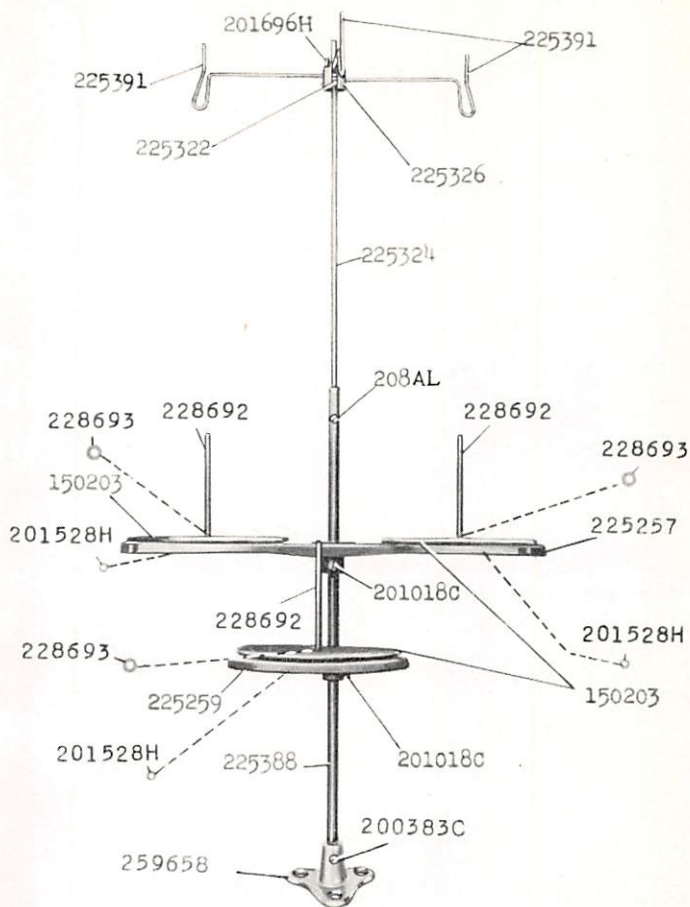

16643 - 3/8

228368

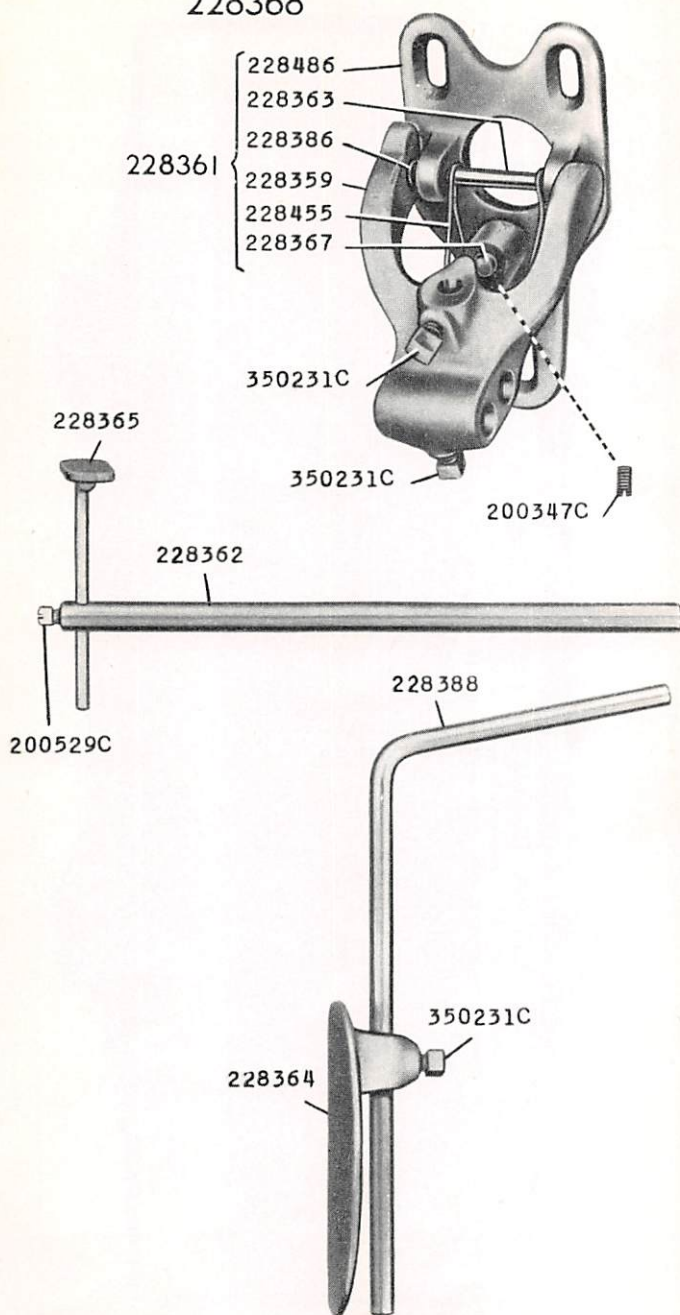

16644 - 1/3

224121

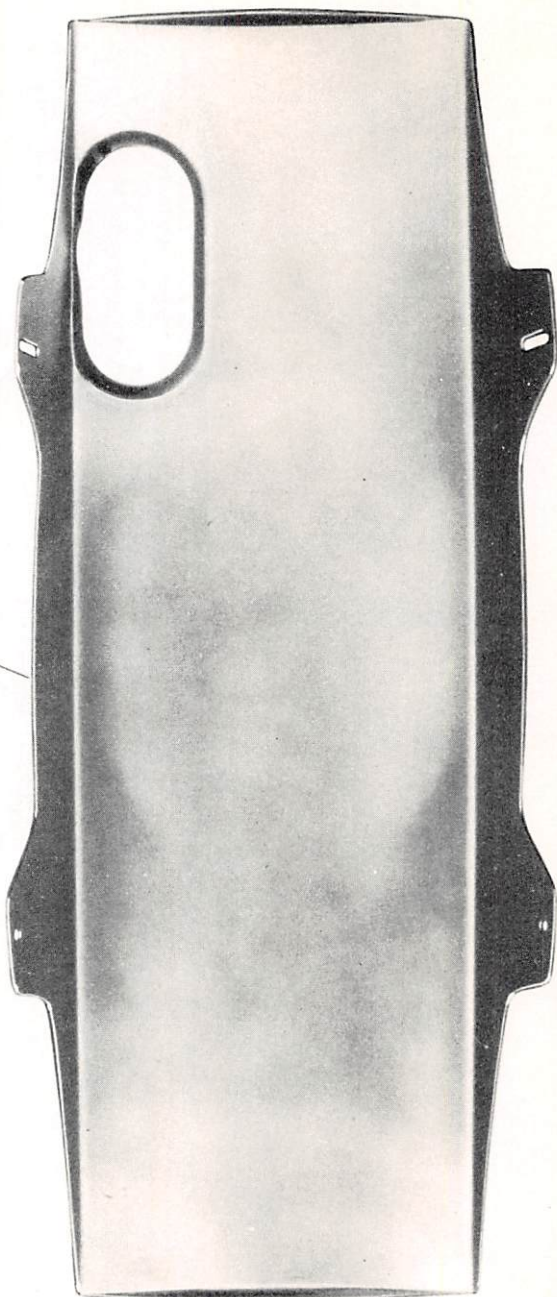

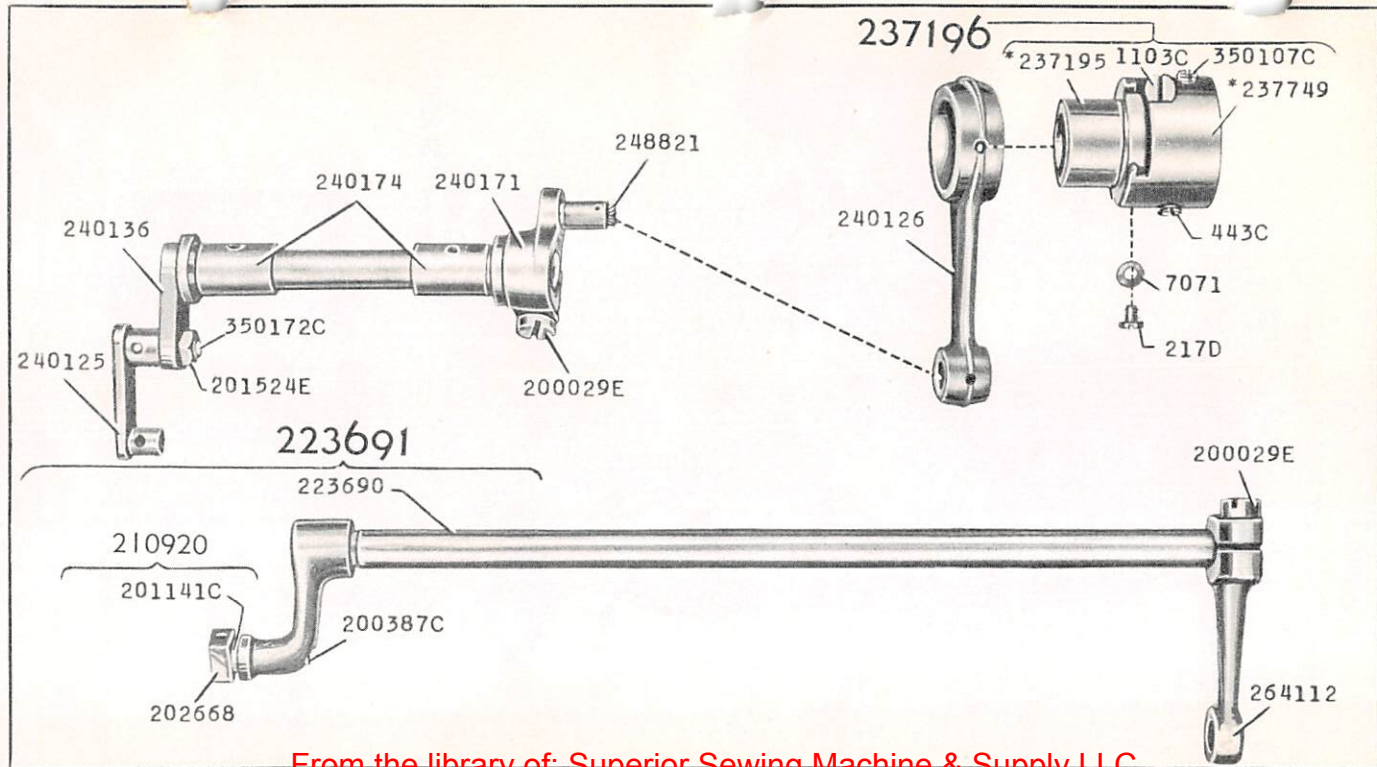

17258-1/2

18312 - 3/8

